

P2C #21-01
JASON 800.377.0628

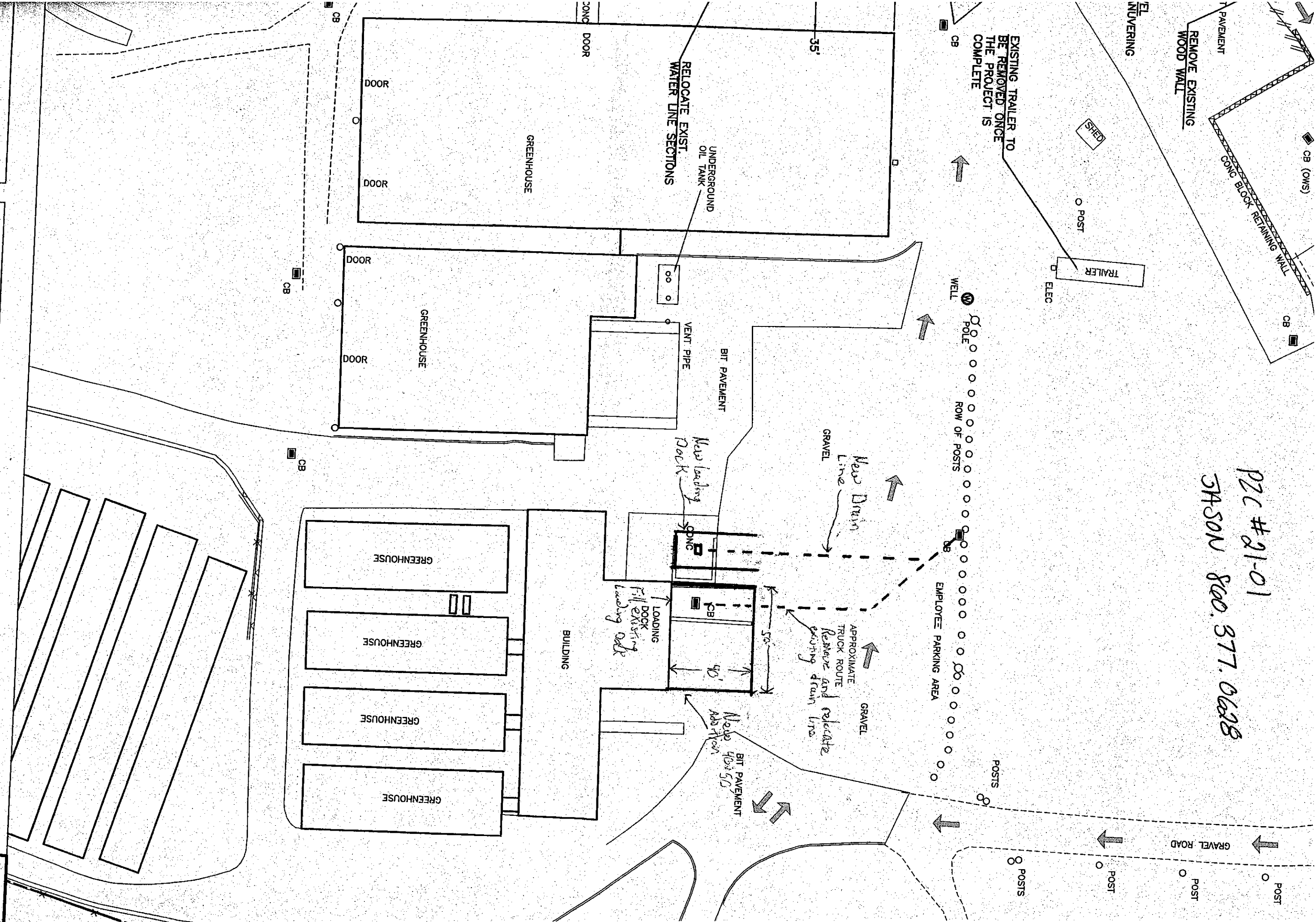

EXISTING TRAILER TO BE REMOVED ONCE THE PROJECT IS COMPLETE

RELOCATE EXIST. WATER LINE SECTIONS

New Drain Line

APPROXIMATE TRUCK ROUTE Remove and relocate existing drain line

BIT PAVEMENT New 40x50 Addition

New Loading Dock

LOADING DOCK EXISTING

SEDIMENT CONTROL PLAN
VOTE OF THE FRANKLIN
ZONING COMMISSION ON:
DATE 10/21/14

APPROVED BY THE FRANKLIN INLAND
WETLANDS COMMISSION
CHAIRPERSON
DATE

RECORD OWNER & SITE PLAN APPLICANT
IRA FEINBERG, 12 WOLCOTT LANE, OLD
LYME, CT 860-642-6030

1. FINAL MW